



CHATTERTON | REES



14b Querrin Street

, London, SW6 2SJ

£750,000



# 14b Querrin Street



## Description

Three bedroom two bathroom split level flat with outside space. The large, bright, reception room is a fantastic space for entertaining with a few period features still in place like the fireplace. The roof terrace is a fantastic addition being larger than average. Towards the rear of the flat you will find a modern kitchen, a well kept bathroom and a double aspect double bedroom. Upstairs is the master bedroom with a further bedroom.

- Share of freehold
- 3 double bedrooms
- 2 bathrooms
- Period building
- Outside space
- Wooden floors

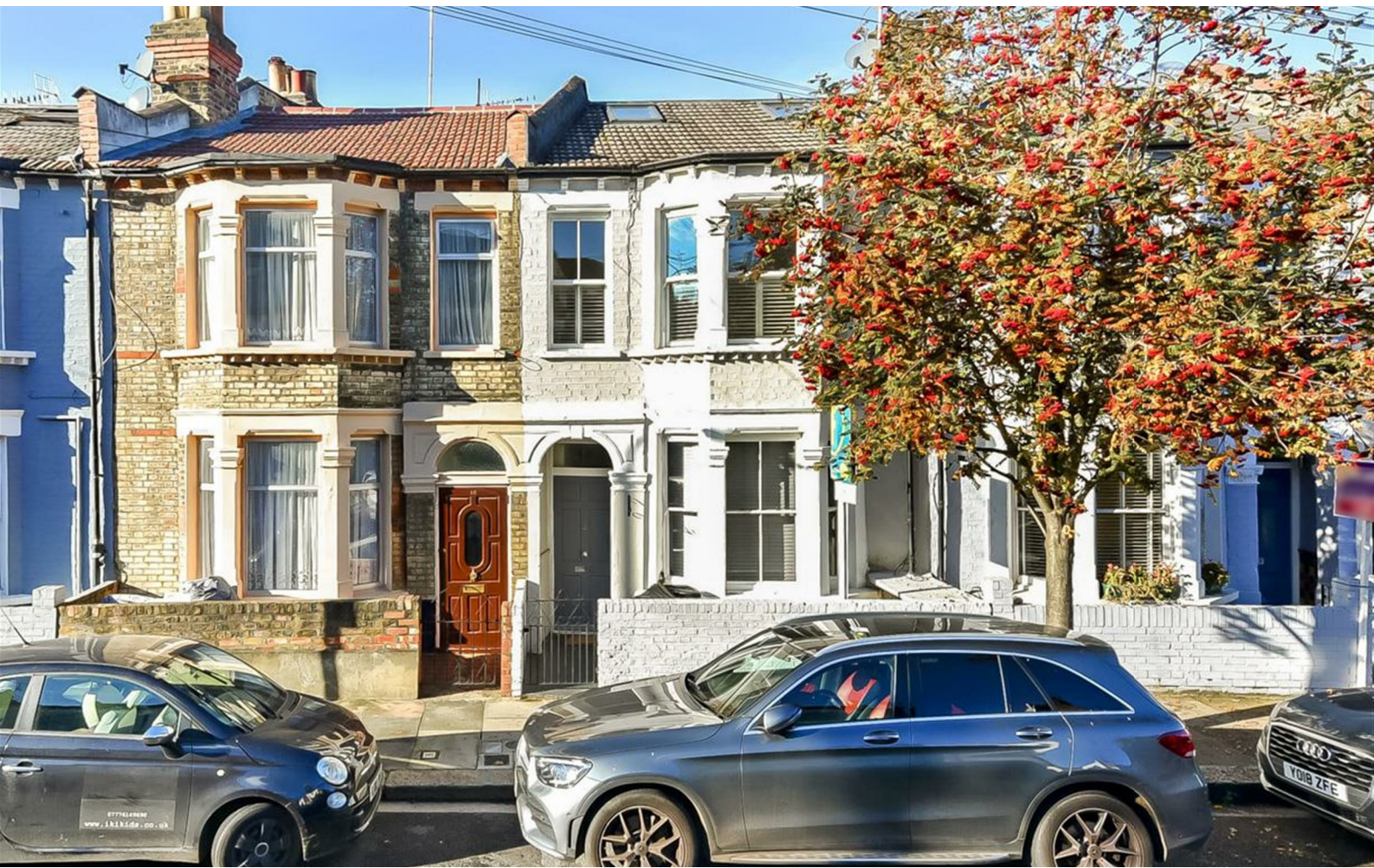



## Floor Plan

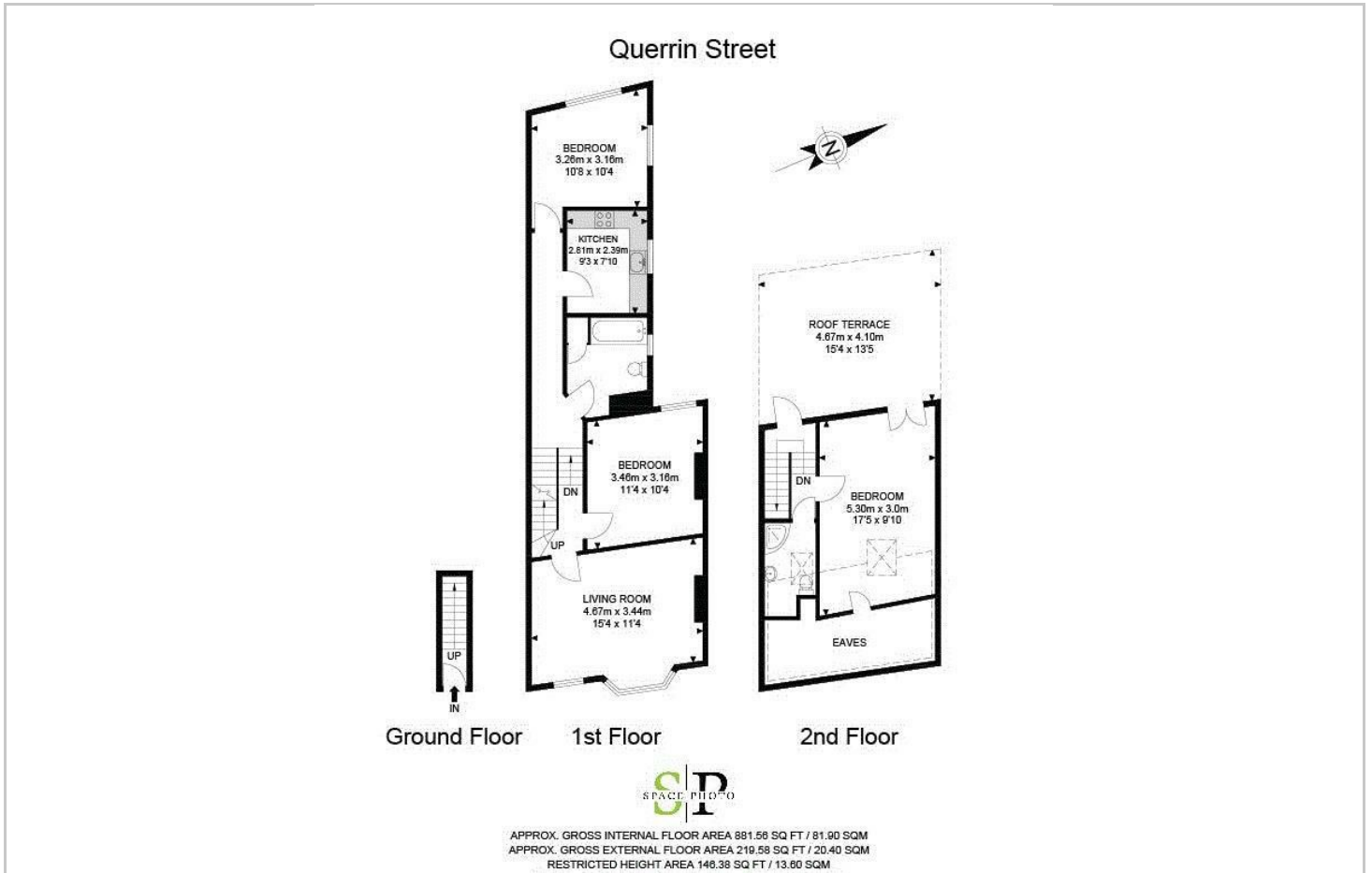

## Area Map



## Viewing

Please contact our Chatterton Rees Office on 020 3780 0580 if you wish to arrange a viewing appointment for this property or require further information.

These particulars, whilst believed to be accurate are set out as a general outline only for guidance and do not constitute any part of an offer or contract. Intending purchasers should not rely on them as statements of representation of fact, but must satisfy themselves by inspection or otherwise as to their accuracy. No person in this firm's employment has the authority to make or give any representation or warranty in respect of the property.

## Energy Efficiency Graph

Energy Efficiency Rating		Current	Potential
Very energy efficient - lower running costs			
(92 plus) <b>A</b>			
(81-91) <b>B</b>			
(69-80) <b>C</b>			
(55-68) <b>D</b>			
(39-54) <b>E</b>			
(21-38) <b>F</b>			
(1-20) <b>G</b>			
Not energy efficient - higher running costs			
<b>England &amp; Wales</b>		EU Directive 2002/91/EC	
Environmental Impact (CO <sub>2</sub> ) Rating		Current	Potential
Very environmentally friendly - lower CO <sub>2</sub> emissions			
(92 plus) <b>A</b>			
(81-91) <b>B</b>			
(69-80) <b>C</b>			
(55-68) <b>D</b>			
(39-54) <b>E</b>			
(21-38) <b>F</b>			
(1-20) <b>G</b>			
Not environmentally friendly - higher CO <sub>2</sub> emissions			
<b>England &amp; Wales</b>		EU Directive 2002/91/EC	